



Project Name:	
Location:	
Item:	Qty:
Model:	

BDCF SERIES

CHEST FREEZERS - SOLID TOP



BDCF-5



BDCF-10R



BDCF-16/2R

FEATURES

CONSTRUCTION

- Steel exterior with a durable white powder coating
- Embossed aluminum interior cabinet and lids
- Manual temperature controller with light up indicators
- Hinged lid opens 90° for easy access to stored items
- Low profile casters for easy moving

TEMPERATURE & COOLING SYSTEM

- Utilize environmentally friendly refrigerant
- Maintain a temperature range of -4°-10°F
- Foamed-in-place polyurethane high density cell insulation throughout the entire cabinet
- Manual defrosting

FEATURES

- Includes wire coated basket for organization inside the unit
- Drain plug allows for easy cleaning
- 7' power cord with NEMA 5-15 plug from the back of the unit
- Integrated external handles
- Lockable lids to keep items safe inside

WARRANTY

- One year parts & labor

Our chest freezers are great for storing bulk food items in any foodservice establishment. Their white powder coated finish is durable and easy to clean. The thick insulated walls and Eco-friendly refrigerant ensures that the freezers will always maintain ideal operating temperatures. Easy to use controller with indicator lights lets you know the status of the machine. The drain plug inside the units allows for easy cleaning. These models are ETL Listed and ETL Sanitation and are backed with a 1 year parts & labor warranty



BDCF SERIES



Specifications subject to change without notice.

For warranty service on these products please call National Service America (NSA) at 1-877-672-7740



Project Name:	
Location:	
Item:	Qty:
Model:	

BDCF SERIES

CHEST FREEZERS - SOLID TOP

PLAN VIEWS

BDCF-5 and BDCF-9R

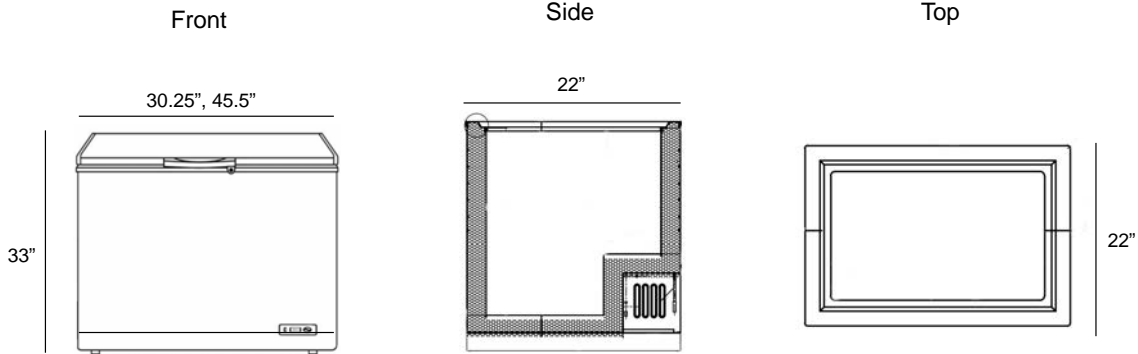

BDCF-10R, BDCF-13R and BDCF-16/2R

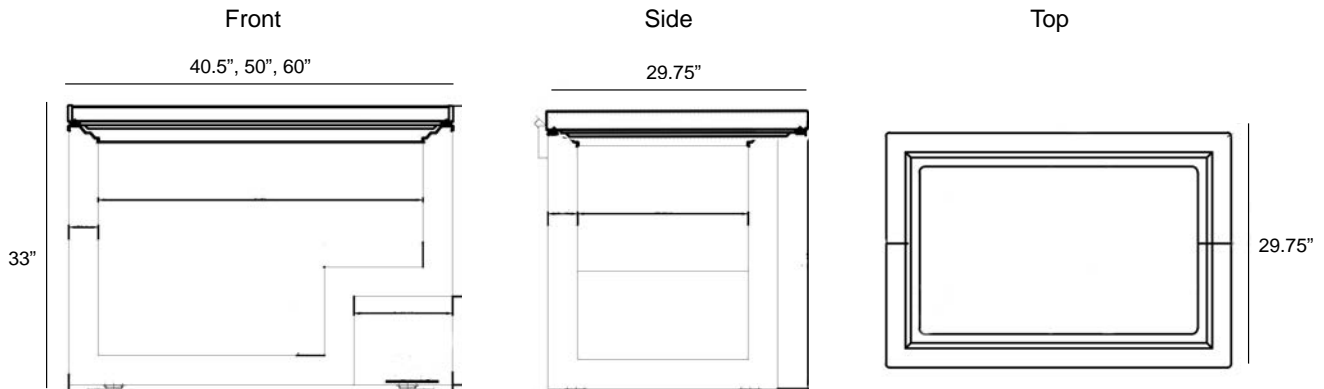

SPECIFICATIONS

Model	Lids	Baskets	Capacity	Overall Dimensions HxWxD (inches)	Refrigerant	Voltage	Watts	Amps	Net Weight	Gross Weight
BDCF-5	1	1	5.4 cu. ft.	33" x 30.25" x 22"	R600a	115V	125W	0.92A	82 lbs	92 lbs
BDCF-9R	1	1	8.7 cu. ft.	33" x 45.5" x 22"	R600a	115V	140W	0.82A	114 lbs	127 lbs
BDCF-10R	1	1	9.6 cu. ft.	33" x 40.5" x 29.75"	R600a	115V	160W	0.71A	119 lbs	136 lbs
BDCF-13R	1	1	12.6 cu. ft.	33" x 50" x 29.75"	R600a	115V	170W	0.67A	134 lbs	152 lbs
BDCF-16/2R	2	1	15.9 cu. ft.	33" x 60" x 29.75"	R290	115V	180W	0.63A	163 lbs	185 lbs