



|               |      |
|---------------|------|
| Project Name: |      |
| Location:     |      |
| Item:         | Qty: |
| Model:        |      |

CDRF-1D/4

## Countertop Refrigerated Merchandiser



This compact 4.2 cubic foot countertop refrigerated merchandiser unit is perfect for businesses such as delis, cafes and diners. Place it near the checkout to boost impulse sales. This unit features 3 wire shelves to display and organize product, bright LED lighting, an eye-catching lighted merchandising sign and a single self-closing glass door for optimal display. This refrigerator boasts a durable black coated exterior and foamed-in-placed polyurethane cell insulation to maintain interior temperatures. This unit is ETL Listed and backed by a 1 year warranty.

### CONSTRUCTION

- Durable black coated steel exterior
- Strong ABS plastic interior
- Foamed-in-place polyurethane insulation for temperature retention
- Full-length glass door is great for displaying bottled drinks or prepackaged snacks
- Top-mounted condenser

### TEMPERATURE

- Mechanical temperature controller makes it easy to adjust the internal temperature
- Environmentally-friendly R600a refrigerant
- Maintains a temperature range of 33°F-40°F
- Manual defrost system

### FEATURES

- Adjustable epoxy-coated shelves allow you to organize the interior to meet your needs
- Bright LED lighting illuminates contents for optimal display
- Eye-catching lighted merchandising sign

### WARRANTY

- One year limited replacement warranty



Berg's continuing commitment to quality products may mean a change in specification or pricing without notice.

For warranty service on these products please call National Service America (NSA) at 1-877-672-7740



|               |      |
|---------------|------|
| Project Name: |      |
| Location:     |      |
| Item:         | Qty: |
| Model:        |      |

## CDRF-1D/4

## Countertop Refrigerated Merchandiser

*This compact 4.2 cubic foot countertop refrigerated merchandiser unit is perfect for businesses such as delis, cafes and diners. Place it near the checkout to boost impulse sales. This unit features 3 wire shelves to display and organize product, bright LED lighting, an eye-catching lighted merchandising sign and a single self-closing glass door for optimal display.*

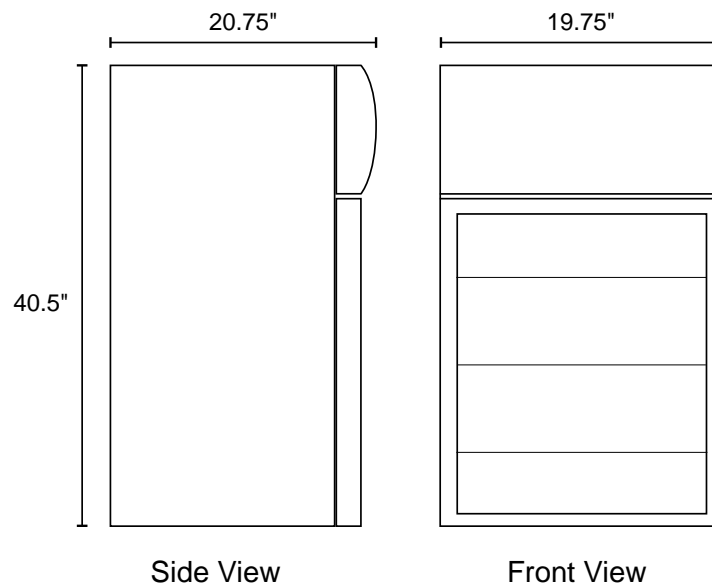

| Model     | Capacity    | Temperature Range | Doors | Shelves | Horsepower | Refrigerant | Volts | Amps |
|-----------|-------------|-------------------|-------|---------|------------|-------------|-------|------|
| CDRF-1D/4 | 4.2 cu. ft. | 33°F – 40°F       | 1     | 3       | 1/5        | R290        | 110V  | 2.2  |

| Exterior Dimensions        | Interior Dimensions     | Net Weight | Gross Weight |
|----------------------------|-------------------------|------------|--------------|
| 19.75"W x 20.75"D x 40.5"H | 16.5"W x 15.75"D x 30"H | 79.5 lbs   | 86 lbs       |

**NEMA 5-15 PLUG**  
120V/15 Amps



This unit comes with a NEMA 5-15 five foot cord.  
Requires a grounded circuit for safe operation.