



ITEM # .....

## Pizza Tables

- EDPT46-B
- EDPT67-B
- EDPT93-B
- EDPT67-2D-B

## STANDARD FEATURES

### ⌘ DURABLE STAINLESS STEEL

Our pizza tables boast a sturdy stainless steel exterior and interior finish. Galvanized back panel provides strength and durability.

### ⌘ ERGONOMICALLY DESIGNED SOLID DOORS

Standard doors come with easy grip handles. Self closing/120° stay open door feature work together for customer convenience

### ⌘ MAGNETIC DOOR GASKET

One piece magnetic gasket is removable without tools for ease of cleaning and replacement. Door's in step design gives added protection to the gasket.

### ⌘ EFFICIENT REFRIGERATION SYSTEM

Factory engineered oversized and balanced refrigeration system. R290 Hydrocarbon refrigerators maintain temperature from 33° to 38 °F. Forced air design underneath pans to keep products fresh

### ⌘ FRONT BREATHING

Allows unrestricted placement of the unit.

### ⌘ HIGH DENSITY POLYURETHANE INSULATION

Ecomate® 2" CFC-free polyurethane insulation foamed in place for extra strength and energy efficiency. Environmentally friendly with zero ozone depletion potential (ODP) and zero global warming potential (GWP).

### ⌘ INSULATED LIDS

Removable insulated lids keep food fresh and cold by reducing condensation

### ⌘ REVERSIBLE & EASY CLEAN CUTTING BOARD

This full length 19" deep cutting board provides ample & comfortable operation space. Made of white polyethylene, it is removable and reversible for durability and easy cleaning.

### ⌘ STANDARD WITH FULL SETS OF 1/3rd PANS, 6" DEPTH

Our EDPT46, EDPT67 and EDPT93 pizza tables come with 6, 9 and 12 top pans respectively. Pans are clear poly carbonate 6" deep. Units can also accommodate 4" deep pans



EDPT46-B



EDPT67-2D-B



EDPT93-B

## ACCESSORIES

Additional epoxy coated shelves.



MODEL	DOORS	DRAWERS	TOP PANS	SHELVES	AMPS.	HP	VOLTAGE	NEMA PLUG	CORD LENGTH	CABINET DIMENSIONS			SHIPPING	
										WIDTH	DEPTH	HEIGHT	WEIGHT	Ft <sup>3</sup>
<b>REFRIGERATION</b>														
EDPT46-B	1	0	6	2	3.0	1/3	115/60/1	5-15P	8'	46"	32½"	39½"	328	63
EDPT67-B	2	0	9	4	3.0	1/3	115/60/1	5-15P	8'	67½"	32½"	39½"	446	73
EDPT93-B	3	0	12	6	3.0	1/3	115/60/1	5-15P	8'	93"	32½"	39½"	556	92
EDPT67-2D-B	1	2	9	2	3.0	1/3	115/60/1	5-15P	8'	67½"	32½"	39½"	446	73

\*Depth does not include 1" rear bumper. \*\*Height does not include 6" overall for casters.



# Pizza Tables

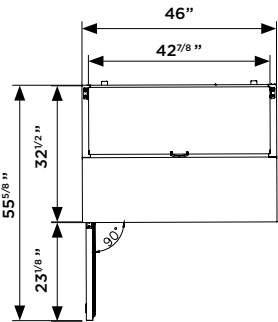

EDPT46-B Top

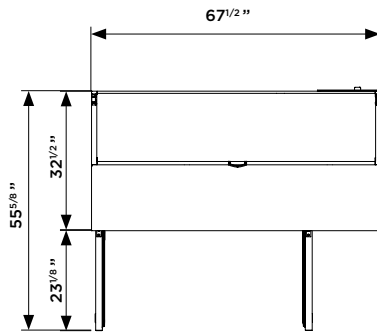

EDPT67-B / EDPT67-2D-B Top

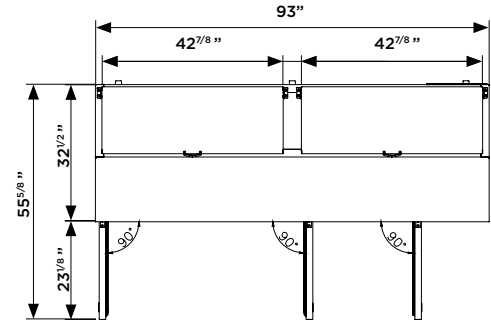

EDPT93-B Top

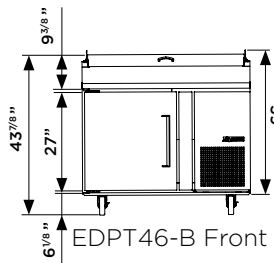

EDPT46-B Front

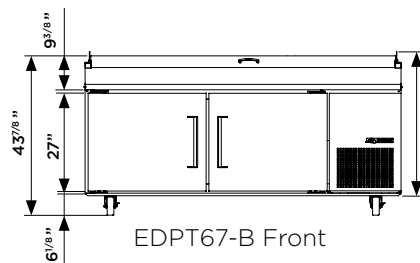

EDPT67-B Front

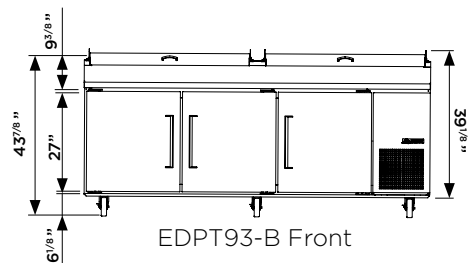

EDPT93-B Front

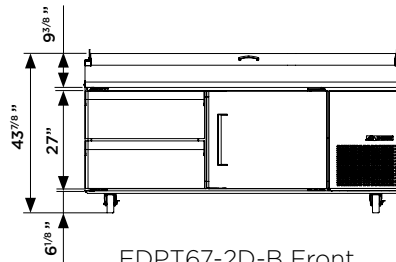

EDPT67-2D-B Front

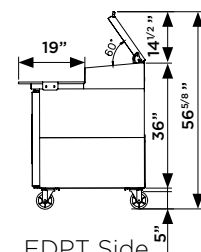

EDPT Side



## \* Specifications



### CABINET CONSTRUCTION

- EXTERIOR: Stainless steel, galvanized steel back.
- INTERIOR: Stainless steel.
- CABINET & DOOR: Entire foamed-in-place high-density, Hydrocarbon, polyurethane insulation. Covered corner floor to meet ETL requirements.
- CASTERS: 5" Diameter swivel casters, front two with brakes.
- SHELVES: Two shelves per door on a rail system that can also accommodate 12"x20" foodservice pans. Pans sold separately.

### REFRIGERATION SYSTEM

- Oversized and balanced refrigeration system.
- R290 holding temperature at 33 °F to 38 °F.
- Self-contained capillary tube system uses environmentally friendly and CFC-free refrigerant.
- Front breathing allows unrestricted placement of the unit.
- Evaporator coil is mounted in the rear of the unit with full accessibility from de back.
- Large fan motor and fan blades for better air circulation.
- Self contained system, no plumbing necessary.
- Acces for the condensing unit behind the front grills slides out for easy cleaning and maintenance.

### DOORS

- Stainless steel exterior.
- One piece magnetic gasket is removable without tools for easy cleaning replacement.
- Self-closing doors with 120° stay open feature and recessed handles for convenient loading and unloading.

### ELECTRICAL

- The whole unit is completely pre-wired at factory with cord and plug set included and ready for final connection to a 115/60/1 phase.

### WARRANTY

- Continental US
- Two year labor and parts warranty.
  - Five year compressor warranty.